

9W LED Driver Constant Current



Features

- Class II&I, SELV, built-in
- Input Voltage 220-240VAC
- Protections: SCP/OLP/OVP
- Power Factor 0.8
- Efficiency $\geq 78\%$
- 5 years warranty

Applications

- LED spot light 、 LED down light 、
- Wall light



Description

SS-9-XXX MB-G is a 9W constant current LED driver that operates from 176-264Vac input with 200 to 700mA output voltage. With it's compact dimensions from 60 x 34 x 23.5mm it is easy to integrate in LED spot, down light and Wall light products. To ensure trouble-free operation, protection is provided against output short circuit and over Load.

Model code

SS-9-XXX MB-G

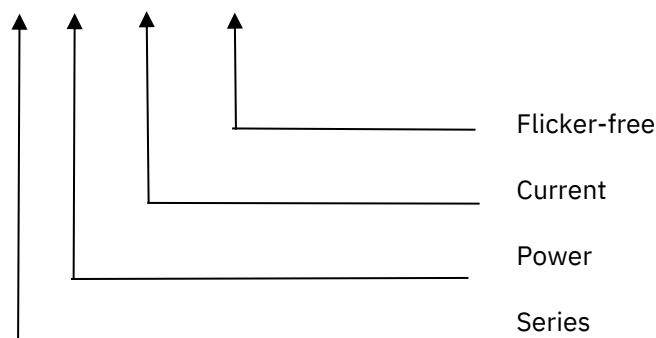

Specification

Output	Constant Current	200mA	300mA	350mA	...	700mA
	Voltage Range	27-45VDC	18-30VDC	15-26VDC	...	7-13VDC
	Unload voltage Max.	55VDC	40VDC	35VDC	...	23VDC
	Current Accuracy	±5%				
	Output HF current ripple(≥1KHz)	±5%				
	Output LF current ripple(≤120Hz)	±5%				
	SVM	≤0.4				
	Pst	≤1				
	Efficiency(Typ.)	≥78%				
Input	Rated input voltage	220-240VAC				
	Range of input voltage	176-264VAC				
	Frequency(Hz)	50/60Hz				
	Displacement factor	≥0.9				
	Power Factor	0.8C				
	Input Current max	0.09A				
	Start-up time	<0.5S				
	No Load Power	≤0.5W				
Protection	Over Load Protection	103-120%				
		YES/Auto Resume				
	Over Voltage Protection	>55VDC	>40VDC	>35VDC	...	>23VDC
		YES/Auto Resume				
	Short circuit Protection	YES/AutoResume				
Environment	Operating Temperature	-20°C~+50°C				
	Humidity	20%-90%RH				
	Tc	75°C				
	Storage Temperature	-40°C~+60°C				
	Lifetime	>44000h@Tc=50°C,230VAC				
Surface	Dimension	60X34X23.5(LXWXH)mm				
s tandards	EN61347-1; EN61347-2-13;EN62384; EN55015;EN61000-3-2 ;EN61000-3-3; EN61547;					
Others	ErP	EU2019/2020				
	RoHS	RoHS(2011/65/EU) (EU)2015/863				
Note	<p>1.All parameters NOT specially mentioned are measured at 240VAC input , full load and 25°C of ambient temperature.</p> <p>2.Ripple & Noise are measured at 20MHz of bandwidth by using a 300mm twisted pair-wire terminated with a 0.1uF & 47 uF parallel capacitor.</p>					

Model list

No	Model number	Input			Output					
		Voltage (VAC)	Max.Current (A)	Frequency (Hz)	Constant current (mA)	Normal working voltage (VDC)	No load working voltage (VDC)	Max. Power(W)		
1	SS-9-200 MB-G	220-240	0.09	50/60	200	27-45	55	9		
2	SS-9-250 MB-G				250	21-36				
3	SS-9-300 MB-G				300	18-30				
4	SS-9-350 MB-G				350	15-26				
5	SS-9-400 MB-G				400	13-22.5				
6	SS-9-450 MB-G				450	11-20				
7	SS-9-500 MB-G				500	8.5-18				
8	SS-9-550 MB-G				550	9-16.5			28	
9	SS-9-600 MB-G				600	9-15			25	9.1
10	SS-9-650 MB-G				650	8-14			24	9
11	SS-9-700 MB-G				700	7-13			23	24

Wiring diagram

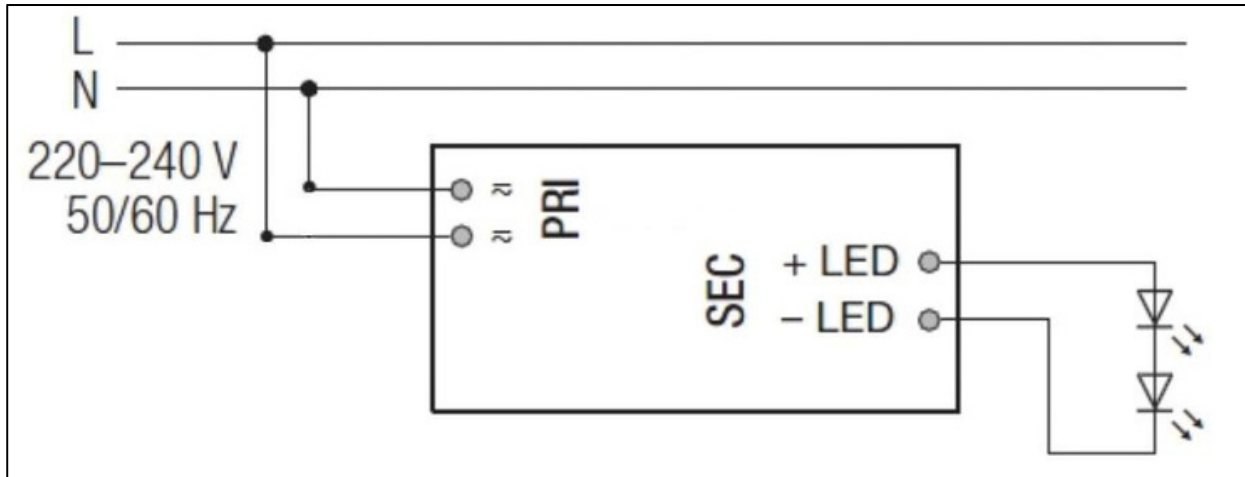

2D diagram

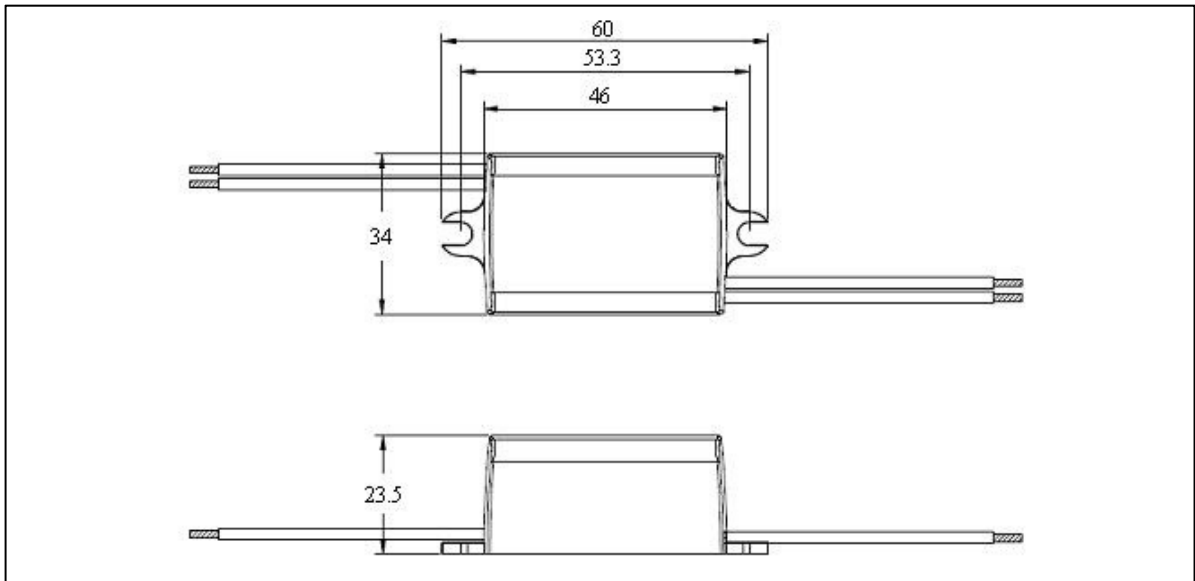

Curve for SS-9-350 MB-G, I_o=350mA

Lifetime vs. Temperature Curve

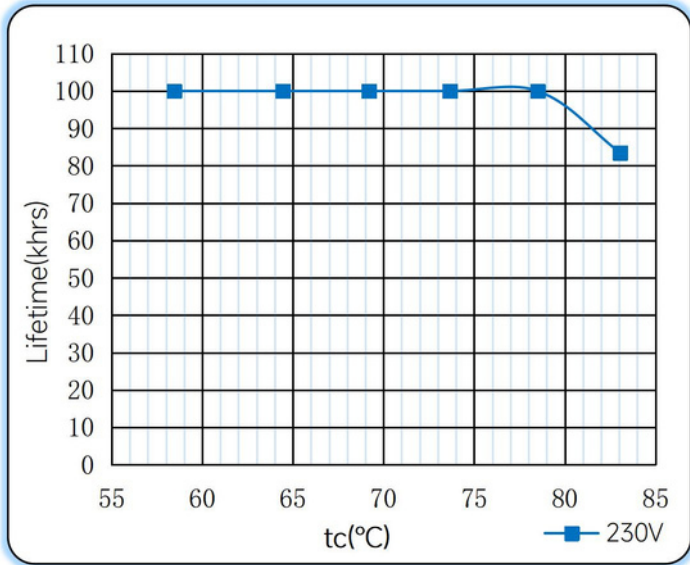

Efficiency vs. Load

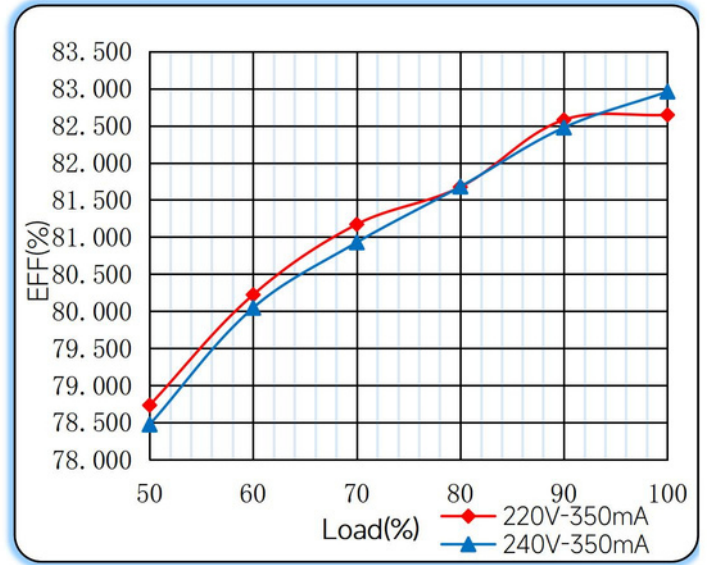

Power Factor Characteristics

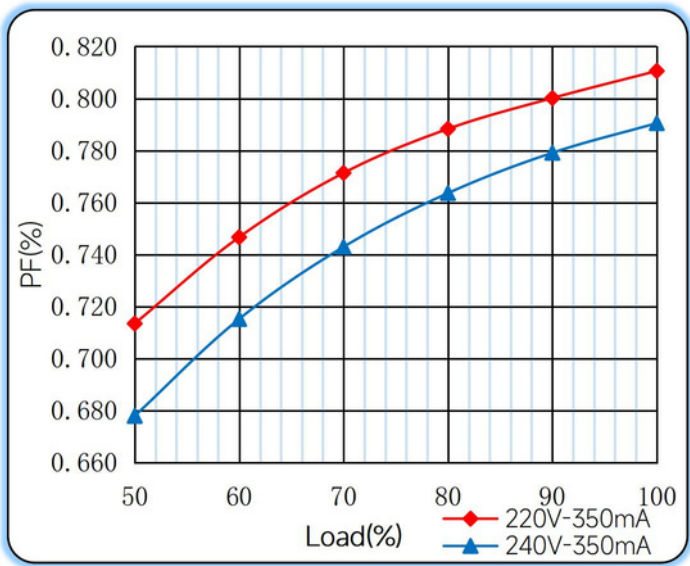

THD vs. Load

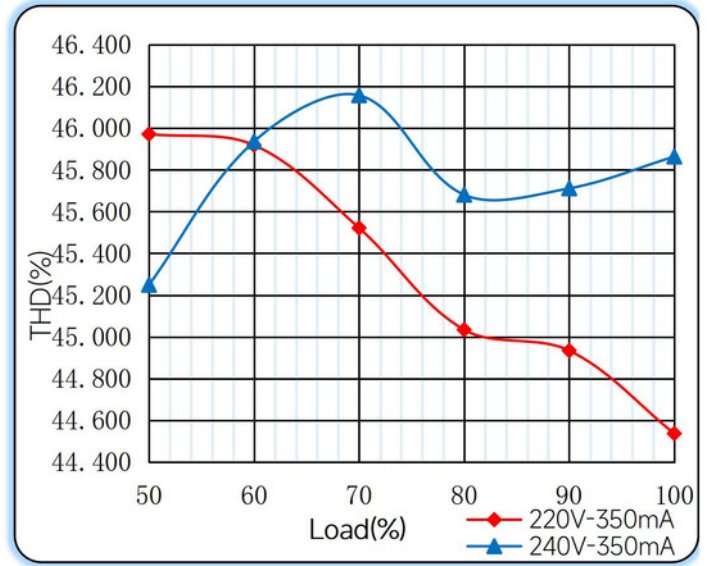

Operating window

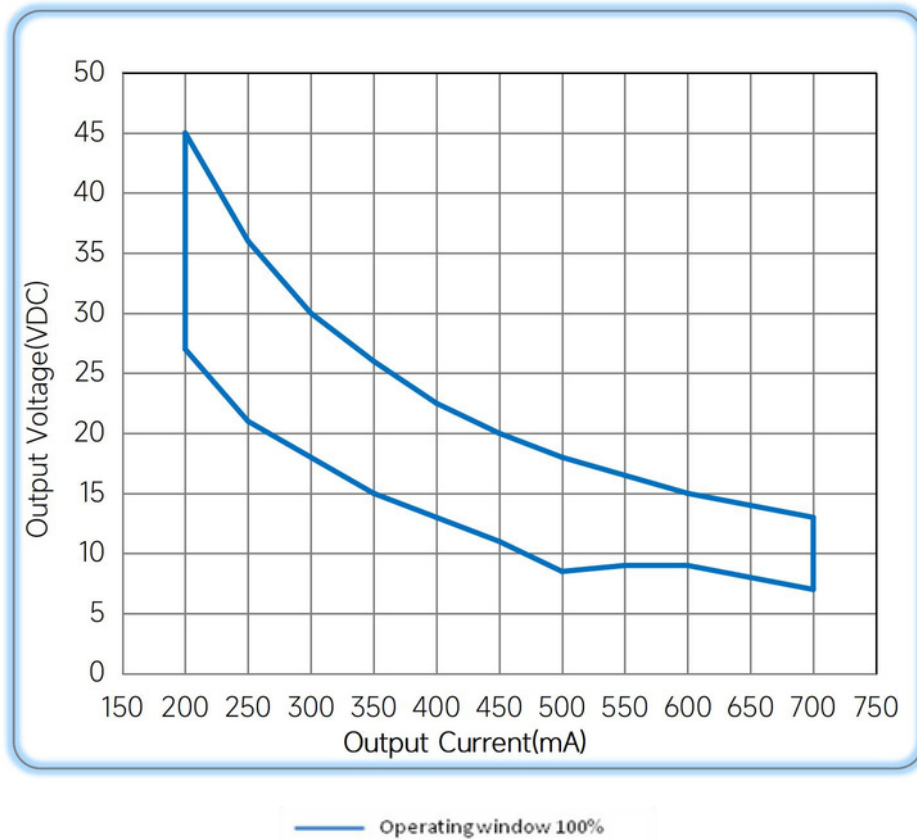

Revision Updates

ITEM	BEFORE	AFTER	VERSION	DATE
Initial			A	2022/05/15